



ALABAMA DEPARTMENT OF TRANSPORTATION

1409 Coliseum Boulevard, Montgomery, Alabama 36110
Bureau of Office Engineer
Plans and Proposals Section
Telephone: 334-242-6444 FAX: 334-264-7976
www.dot.state.al.us



Kay Ivey
Governor

John R. Cooper
Transportation Director

February 20, 2024

MEMORANDUM

To: Proposal Holders

From: Bryan E. Nichols 
Assistant Bureau Chief

Subject: HPP-TAPBH-CMAQ-A104(916)
Jefferson County
February 23, 2024 Letting

Enclosed is the Revised Plan Sheet Nos, 1A & 24W for the above referenced project. Please see attached letter from Mr. DeJarvis Leonard, P.E., dated February 20, 2024.

It is the bidder's responsibility to notify vendors, suppliers and subcontractors of this change.

This change must be incorporated into your proposal and used in the preparation of your bid. Failure to do so may cause your bid to be considered irregular and non-responsive and may result in the automatic rejection of your bid.

BEN/jss

Attachment

cc: Mr. DeJarvis Leonard, P.E. Mr. Stacey Glass, P.E.



Kay Ivey
Governor

ALABAMA
DEPARTMENT OF TRANSPORTATION

EAST CENTRAL REGION
OFFICE OF REGIONAL ENGINEER
100 CORPORATE PARKWAY
SUITE 450
HOOVER, AL 35242
P.O. BOX 382348
BIRMINGHAM, AL 35238-2348
TELEPHONE: (205) 327-4962



John R. Cooper
Transportation Director

February 20, 2024

Mr. Joe Lister, Jr., P.E.
State Office Transportation Engineer
Alabama Department of Transportation
1409 Coliseum Boulevard
Montgomery, Alabama 36110

ATTN: Robert Peyton

RE: Project No. HPP-TAPBH-A104(916)
CPMS No. 100051157
Pedestrian Walkway Over US-21 in Vestavia Hills Near Wald Park
Vestavia Hills, Alabama
Jefferson County

Dear Mr. Lister:

Attached are revised sheets 1A and 24W with the changes as follows: Sheet 1A, flagged revisions for Sheet 24W; Sheet 24W, removed anti climb fence note.

Sincerely,
DeJarvis Leonard, P.E.
Region Engineer

Richard K. Topping
Asst. Local Transportation Engineer- Birmingham Area Office

DL/GMB/RKT/sj
attachment
pc: file

INDEX TO SHEETS

REFERENCE PROJECT NO	FISCAL YEAR	SHEET NO
HPP-TAPBH- CMAQ-A104(916)	2024	1A

SHEET NO	DESCRIPTION	SHEET NO	DESCRIPTION
1	TITLE SHEET	23-B	BRIDGE PLANS - FOUNDATION LAYOUT
1A	INDEX TO SHEETS	23C	BRIDGE PLANS - FENCING DETAILS
1-B	INDEX TO SPECIAL AND STANDARD DRAWINGS	23-D	BRIDGE PLANS - TYPICAL SECTIONS
1C	PLANS LEGEND SHEET	23E	BRIDGE PLANS - ABUTMENT NO. 1
1-D	PLANS ABBREVIATIONS SHEET	23F	BRIDGE PLANS - BENT NO. 2
1E	PRIMARY SURVEY CONTROL SHEET	23G	BRIDGE PLANS - BENT NO. 2 DETAILS
1F	GEOMETRIC DATA SHEET	23H	BRIDGE PLANS - BENT NO. 3
2	TYPICAL SECTIONS	23-I	BRIDGE PLANS - BENT NO. 3 DETAILS
2A	TYPICAL DETAIL SHEET	23J - 23-O	OMITTED
2-B	PROJECT NOTES	23P	BRIDGE PLANS - BORING LOCATION PLAN
2C	GENERAL TRAFFIC CONTROL PLAN NOTES	23Q	BRIDGE PLANS - BORING LOG PROFILE
2D - 2E	ITS PLAN NOTES	23R	BRIDGE PLANS - TEST BORING RECORD
3 - 3E	SUMMARY OF QUANTITIES	23S	BRIDGE SPECIAL PROJECT DETAIL: STANDARD BRIDGE NOTES
4	PLAN SHEET	23T - 23U	BRIDGE SPECIAL PROJECT DETAIL: BRIDGE STANDARD DETAILS
4A	PROFILE SHEET: US-31 CENTERLINE	23V	BRIDGE SPECIAL PROJECT DETAIL: TRAFFIC PROTECTION
4-B	PROFILE SHEET: BRIDGE	24	OMITTED
4C	PROFILE SHEET: LIBRARY STAIRS & TOWER DRAINS	24A	GENERAL ARCHITECTURAL DRAWINGS - PROJECT INFORMATION
4-D	PROFILE SHEET: SIDEWALKS	24B - 24D	STRUCTURAL DRAWINGS - GENERAL NOTES
5 - 5A	BLOW-UP DETAILS	24E	STRUCTURAL DRAWINGS - TYPICAL DETAILS
6 - 7	OMITTED	24F	STRUCTURAL DRAWINGS - ABBREVIATIONS & SYBMDLS
8	UTILITY SHEET	24G - 24H	STRUCTURAL DRAWINGS - SPECIAL INSPECTIONS
8A	WATER DETAIL SHEET	24-I	STRUCTURAL DRAWINGS - ELEVATOR & STAIR PLANS
8B - 8D	WATERMAIN RELOCATION PLAN (BWMB)	24J - 24L	STRUCTURAL DRAWINGS - SECTIONS
9	TRAFFIC SIGNAL AND ITS LEGEND	24M	ARCHITECTURAL DRAWINGS - OVERALL FLOOR PLANS
9A	ITS PLAN LAYOUT (SITE #1 - REQUIRED)	24N	ARCHITECTURAL DRAWINGS - ENLARGED FLOOR PLANS
9B	ITS PLAN LAYOUT (SITE #2 - REQUIRED)	24-O	ARCHITECTURAL DRAWINGS - ROOF PLAN AND RCP
9C	ITS PLAN LAYOUT (SITE #3 - REQUIRED)	24-P - 24Q	ARCHITECTURAL DRAWINGS - EXTERIOR ELEVATIONS
9D	ITS PLAN LAYOUT (SITE #1 - REMOVAL)	24R	ARCHITECTURAL DRAWINGS - BUILDING SECTIONS
9E	ITS PLAN LAYOUT (SITE #2 - REMOVAL)	24S	ARCHITECTURAL DRAWINGS - WALL SECTIONS
9F	ITS PLAN LAYOUT (SITE #3 - REMOVAL)	24T	ARCHITECTURAL DRAWINGS - STAIR SECTIONS AND DETAILS
9G	SPECIAL PROJECT DETAIL: FIBER DIAGRAM	24U - 24V	ARCHITECTURAL DRAWINGS - MISCELLANEOUS DETAILS
9H	SPECIAL PROJECT DETAIL: OPTICAL CABLE FIBER ROUTING DIAGRAM	24W	ARCHITECTURAL DRAWINGS - FENCE PANELS DIMENSION
9-I	SPECIAL PROJECT DETAIL: ITS FIBER ALLOCATION CHART	24X	PLUMBING - SCHEDULE, LEGENDS & DETAILS
9J	SPECIAL PROJECT DETAIL: ITS SPLICE CHART TABLE AND SPLICE TYPE TABLES	24Y	PLUMBING - FLOOR PLANS
10	ROADWAY LIGHTING PLAN LAYOUT	24Z	MECHANICAL PLAN
11 - 12	OMITTED	24AA	ELECTRICAL LEGEND AND NOTES
13	TRAFFIC CONTROL PLAN: SUMMARY OF QUANTITIES AND SEQUENCE OF CONSTRUCTION	24BB	ELECTRICAL LEGEND NOTES AND DETAILS
13A	TRAFFIC CONTROL PLAN: DETAILS	24CC	ELECTRICAL DETAILS & SCHEDULES
14	SPECIAL PROJECT DETAIL: STANDARD DETAILS FOR TRAFFIC CONTROL PLANS	24DD	ELECTRICAL LIGHTING PLANS
15	SPECIAL PROJECT DETAIL: STANDARD DETAILS FOR TRAFFIC CONTROL PLANS	24EE	ELECTRICAL POWER/AUXILIARY PLANS
16	SPECIAL PROJECT DETAIL: DETAILS FOR MULTILANE DIVIDED HIGHWAY LANE CLOSURES	24FF	ELECTRICAL ELEVATIONS
17	SPECIAL PROJECT DETAIL: DETAILS FOR FREEWAY AND INTERSTATE HIGHWAY SHOULDER CLOSURES	24GG	ELECTRICAL SECTION ISOMETRIC VIEWS
18	SPECIAL PROJECT DETAIL: DETAILS FOR TEMPORARY ROAD CLOSURE FOR MULTILANE DIVIDED OR INTERSTATE HIGHWAYS	24HH	SECURITY LEGENDS & SCHEDULES
19	SPECIAL PROJECT DETAIL: TYPICAL PLACEMENT OF ADVANCE WARNING SIGNS FOR MULTILANE DIVIDED HIGHWAYS (NO SPEED REDUCTION)	24II	SECURITY PLANS
20	OMITTED	24JJ	SECURITY ELEVATIONS
21	SIDEWALK CLOSURE DETAIL	24KK	SECURITY DETAILS
22	OMITTED	24LL	SECURITY SPECIFICATIONS
23	BRIDGE PLANS - INDEX TO BRIDGE SHEETS, STANDARD NOTES AND ESTIMATED QUANTITIES	25 - 26	OMITTED
23A	BRIDGE PLANS - PLAN AND ELEVATION	27	EROSION & SEDIMENT CONTROL PLAN LEGEND
		28	EROSION & SEDIMENT CONTROL PLAN (INITIAL)
		29	EROSION & SEDIMENT CONTROL PLAN (INTERMEDIATE)
		30	EROSION & SEDIMENT CONTROL PLAN (FINAL)

2/16/2024
 Revised Sheet 24W
 KD

11:40:40 AM 2/16/2024 cor|let| pw|greshams|th-pw.bent|ey.com|greshams|th-pw-01|Documents|Projects|286xx|28668.02|01|Work|CAD|Project_Design|Plans_Assembly|50996_001A_IDX_01.dgn

RESPONSIBLE PE: LESLIE B. CORLETT, PE	SUPERVISOR: BLAIR C PERRY, PE	DESIGNER: LESLIE B. CORLETT, PE	PLAN SUBMITTAL	ALABAMA DEPARTMENT OF TRANSPORTATION	NOT TO SCALE	SHEET TITLE	ROUTE
DATE: 11/15/23	DATE: 11/15/23	DATE: 11/15/23				INDEX TO SHEETS	US-31

ARCHITECTURAL DRAWINGS - FENCE PANEL DIMENSION

REFERENCE PROJECT NO HPP-TAPBH-CMAQ-A104(916)	FISCAL YEAR 2024	SHEET NO 24W
--	---------------------	-----------------

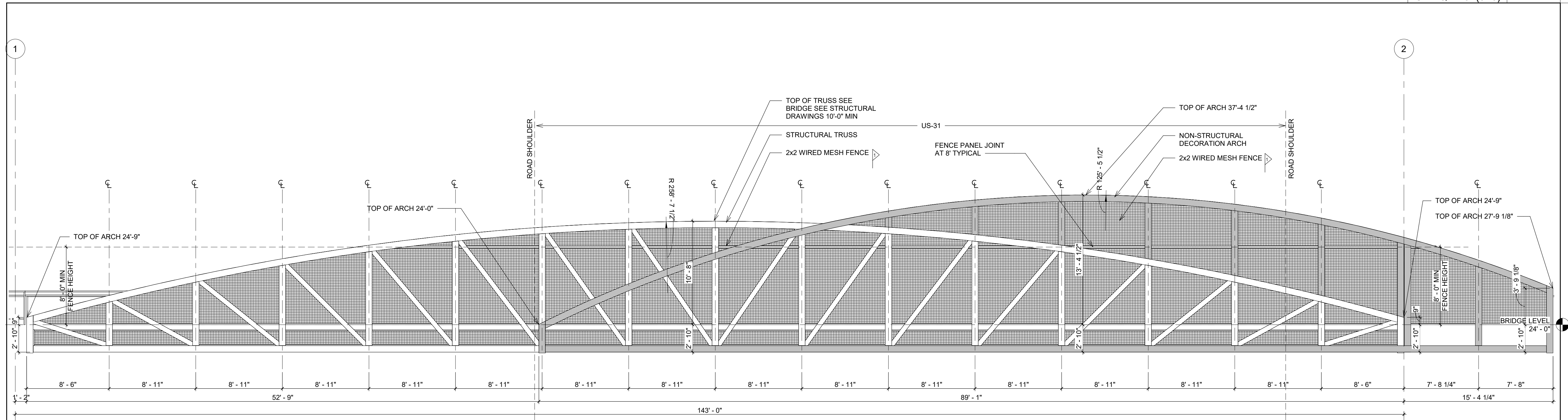

1 FENCE PANEL SOUTH ELEVATION FACING NORTH
3/16" = 1'-0"

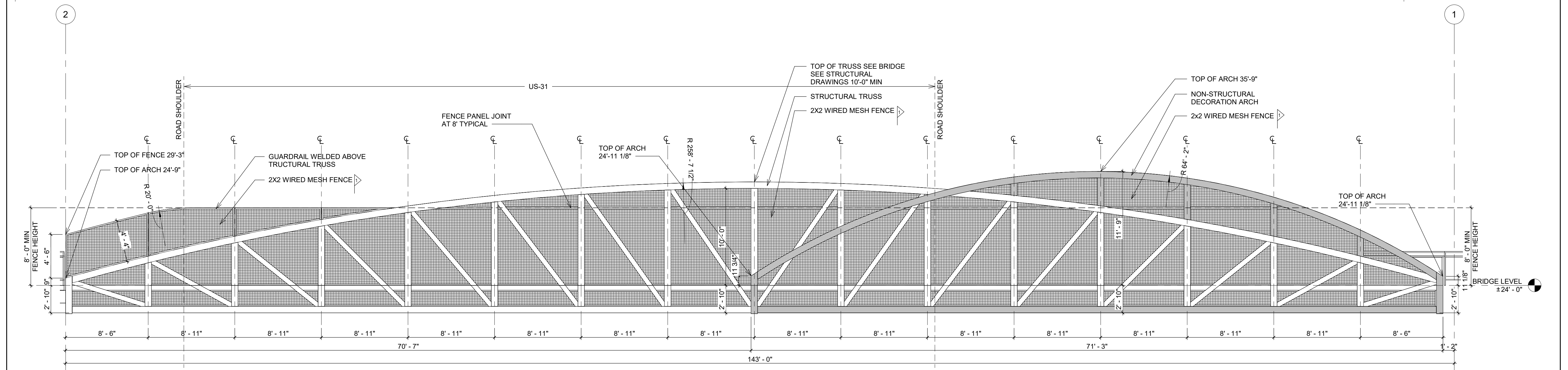
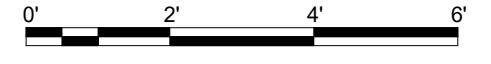

2 FENCE PANEL NORTH ELEVATION FACING SOUTH
3/16" = 1'-0"

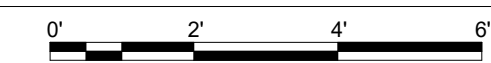

NOTE:
DIMENSIONS IN THIS DRAWING SHOW ARCHITECTURAL DESIGN INTENT FOR AESTHETIC PURPOSES AS THE BRIDGE CONTRACTOR'S BASE DESIGN OF THE BRIDGE STRUCTURAL. THE FINAL BRIDGE DESIGN SHALL BE AS CLOSE AS POSSIBLE TO THE BASE DESIGN AND APPROVAL BY THE ARCHITECT

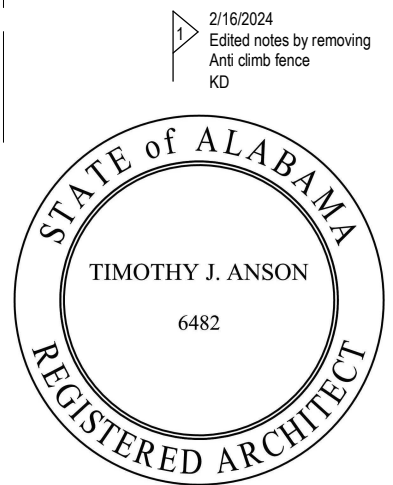

2/16/2024 10:43:48 AM Autodesk Docs://286688.00 Vestavia Hills Pedestrian Bridge R22/286688.00 ArchCentral_VestaviaHillsPedestrianBridge_R22.rvt

RESPONSIBLE ARCH: TIM ANSON, AIA	SUPERVISOR: JONAS BOOKER, AIA	DESIGNER: EDDY ALONSO, AIA	PLAN SUBMITTAL		ALABAMA DEPARTMENT OF TRANSPORTATION GRESHAM SMITH		SHEET TITLE	ROUTE
DATE 11/15/2023	DATE 11/15/2023	DATE 11/15/2023					ARCHITECTURAL DRAWINGS - FENCE PANEL DIMENSION	US-31